



# Air Handling Units

## Product Catalogue 2025





# Air Handling Units

▪ Daikin air handling units	4
▪ Products overview	8
▪ The working principle at a glance	10
▪ Professional	12
▪ Daikin Digital Control	14
▪ Modular R	16
▪ Modular P	17
▪ Compact L	18
▪ Compact T	19
▪ Compact L&T accessories	20
▪ Daikin fresh air package	22





# Why choose Daikin air handling units?

- Maximum energy efficiency and indoor air quality
- Wide range of functions and options
- **High quality** components
- **Innovative** technology: Unique features and state of the art technology for short payback
- Operation **efficiency** and **energy savings**
- Outstanding **reliability** and **performance**
- Various applications are possible including air conditioning applications, industry-type process cooling, and large-scale district heat source systems
- Plug and play concept for easy installation and commissioning
- Unique Daikin fresh air package available for connection of AHU to VRV or ERQ

## Certifications

- Eurovent certified performances
- Exceeding 2018 ErP – ECODESIGN requirements
- Certified according to the Hygiene Directive VDI 6022 (Professional ranges)
- Certified according to the Hygiene Directive DIN 1946 (Professional range)
- RLT certified performances



The unique quality of Daikin AHU is accomplished by:

### Panels

- Inner and outer panels available in different materials (pre-painted, aluminium, stainless steel, etc.) to meet all project specifications

### Gasket

- Liquid gasket technology drastically reduces unit air leakage

### Frame

- All anodized aluminium which has the highest corrosion resistance compared to natural aluminium
- Unique Daikin thermal break (35 mm or 27 mm thermal break). Polyamide bars design to enhance thermal break unit performances
- Distinctive Section to section thermal break profile to ensure thermal break design on the whole unit
- Rounded profile for increased ease of cleaning

### IAQ

- Flush internal surface and rounded corner flush surface to avoid the retention of dirt and to be easily cleanable
- Wide filtration possibility to reduce pollution

### Plug & Play Controls

- Pre-commissioned and Factory-tested control for quicker on site commissioning
- Sole manufacturer to provide a complete AHU DX solution from a single manufacturer available for connection of AHU to VRV or ERQ (everything factory-mounted)



## Marketing tools

- Watch the time-lapse video of a Daikin AHU construction on [www.youtube.com/daikineurope](http://www.youtube.com/daikineurope)
- Watch the Compact L promotional video on [www.youtube.com/daikineurope](http://www.youtube.com/daikineurope)
- Download our brochure on air handling units from [my.daikin.eu](http://my.daikin.eu)
- Get the access to the selection tool <http://tools.daikinapplied.eu> to select your air handling units in a few clicks.
- Consult the "Argue Card" document to support in promoting the Compact L and T range (available on request – refer to your Daikin AHU specialist)

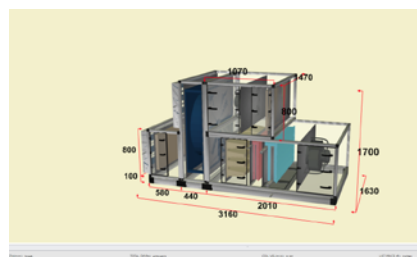
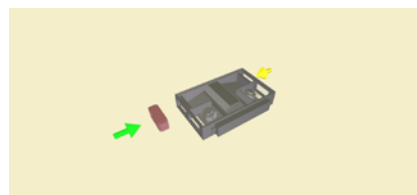

## BIM models

- Get the Compact L and T BIM models on [bim.daikin.eu](http://bim.daikin.eu)
- Get the BIM tool plugin for Revit for Professional and Modular R/P series

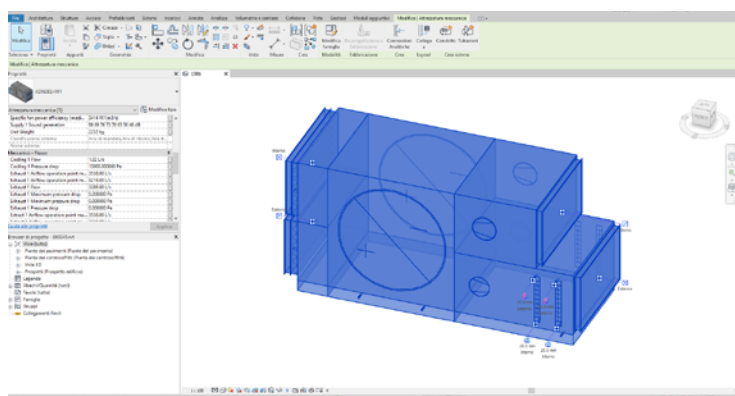

## Benefits for the installer

### Plug and play design

- Pre-programmed and factory-tested controls for an easier and fast commissioning
- Low voltage fast connectors between AHU sections
- Flush mounted or external electrical control panel

### Daikin Fresh air package

- Plug & Play connection of Professional or Modular AHU to Daikin VRV and ERQ
- Factory-mounted package contains expansion valves, electronic interface and sensors

## Benefits for the consultant

### Quick selection tool

- In-house developed web software with improved user interface and preset parameters ensure that you can always find the optimum and most energy efficient product for your application
- Extremely flexible design
- Infinite variable sizes (increments of 1 cm)

### BIM models

- Regardless if your AHU is standard or fully customized, BIM models are available and can be downloaded with just a few clicks

## Benefits for the end user

### Customized or standard

- Amazing tailor-made capability to meet the specific customer needs with the Professional range or fast availability thanks to the "make to stock" standard Compact L and T range

### Efficient control logic

- Open communication protocols (BACnet and Modbus) that guarantee BMS, and iTM compatibility
- Energy efficient controls with reduced energy and operating cost
- Highest efficiency ensure savings on energy consumption costs



Smart controls

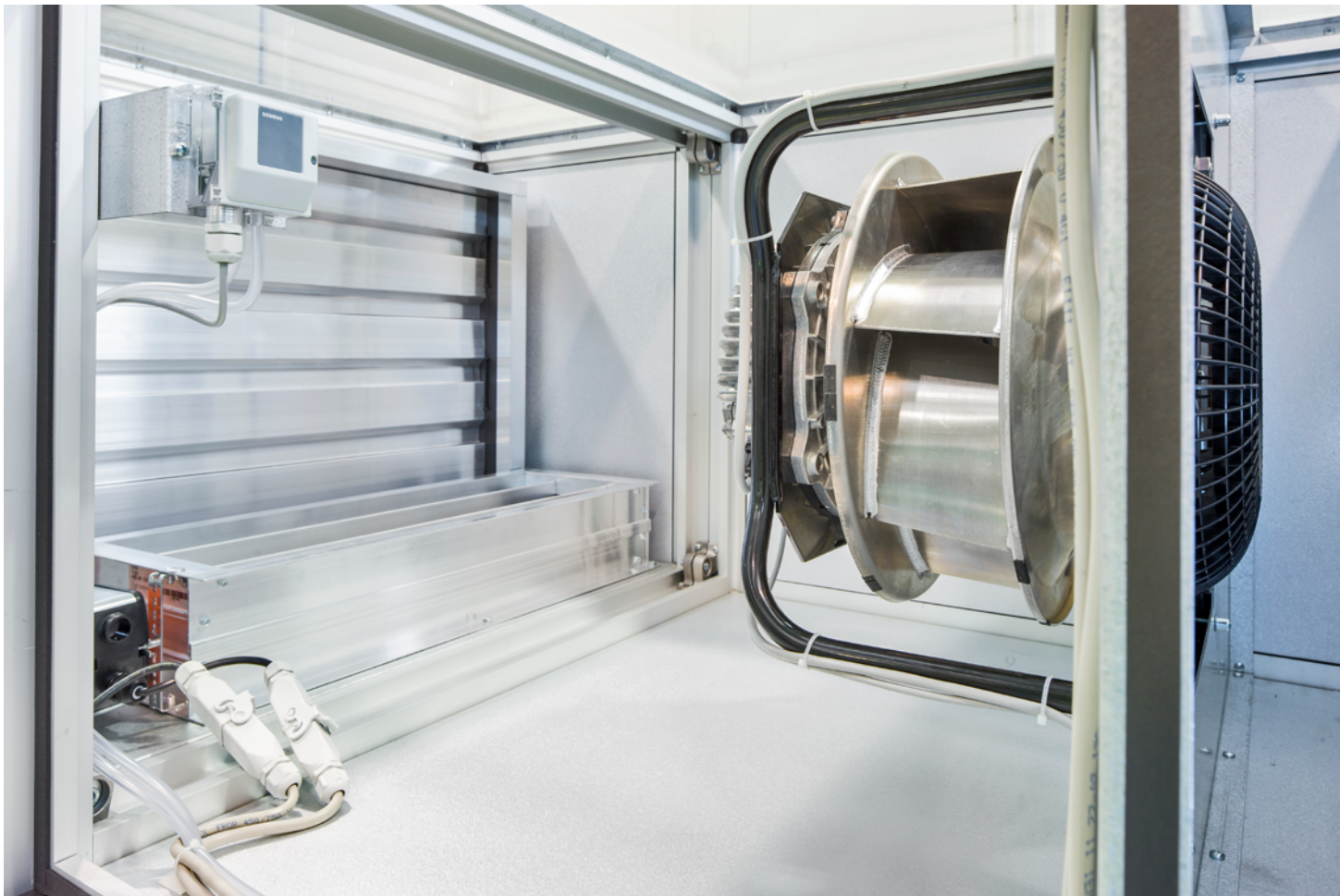

Damper and EC fan





D-AHU Modular R installation



Heat recovery wheel and filter



D-AHU Professional installation



# Products overview

## Centralized ventilation

### D-AHU Professional

- Infinite variable sizes
- Tailored to the individual customer



750 m³/h  
up to 144,000 m³/h

### D-AHU Modular R

- Pre-configured sizes
- Plug and play concept
- EC Fan technology
- Heat recovery wheel (sorption and sensible technology)
- Modular design



500 m³/h  
up to 25,000 m³/h

### D-AHU Modular P

- Pre-configured sizes
- Plug and play concept
- EC Fan technology
- High efficiency aluminium counter flow PHE
- Modular design



500 m³/h  
up to 25,000 m³/h

## Eurovent certification

Daikin Applied Europe S.p.A. participates in the Eurovent Certified Performance programme for Air Handling Units. Check ongoing validity of certificate: [www.eurovent-certification.com](http://www.eurovent-certification.com) or [www.certiflash.com](http://www.certiflash.com)



Result Energy TermiC° S2&F2

Eurovent Classification according to EN1886

D1	Casing strength class	D1	D2	D3		
	Max. relative deflection mm x m <sup>-1</sup>	4.00	10.00	Exceeding10		
L1	Casing air leakage class at -400 Pa	L1	L2	L3		
	Max. leakage rate (f <sub>400</sub> ) l x s <sup>-1</sup> x m <sup>-2</sup>	0.15	0.44	1.32		
L1	Casing air leakage lass at +700 Pa	L1	L2	L3		
	Max. leakage rate (f <sub>700</sub> ) l x s <sup>-1</sup> x m <sup>-2</sup>	0.22	0.63	1.90		
ePM <sub>1</sub> 80% (F9)	Filter bypass leakage class	ePM <sub>1</sub> 80% (F9)	ePM <sub>1</sub> 70% (F8)	ePM <sub>1</sub> 50% (F7)	ePM <sub>2.5</sub> 50% (M6)	ISO Coarse
	Max. filter bypass leakage rate k in % of the volume flow rate	0.50	1	2	4	6
T2	Thermal transmittance	T1	T2	T3	T4	T5
	(U) W x m <sup>-2</sup> x K <sup>-1</sup>	U <= 0.5	0.5 < U <= 1	1 < U <= 1.4	1.4 < U <= 2	No requirements
TB2	Thermal bridging factor	TB1	TB2	TB3	TB4	TB5
	(kb)	0.75 < K <sub>b</sub> <= 1	0.6 < K <sub>b</sub> <= 0.75	0.45 < K <sub>b</sub> <= 0.6	0.3 < K <sub>b</sub> <= 0.45	No requirements

## Decentralized ventilation

### Compact L

- Pre-configured sizes
- Plug and play concept
- EC Fan technology
- High efficiency aluminium counter flow PHE
- Low height unit
- For false ceiling applications

### Compact T

- Pre-configured sizes
- Plug and play concept
- EC Fan technology
- Small footprint
- Compact design
- High efficiency aluminium counter flow PHE
- Top connected unit

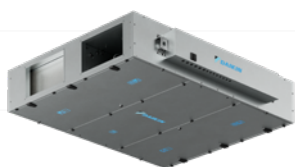

150 m³/h  
up to 4,000 m³/h

200 m³/h  
up to 4,200 m³/h

## Centralized ventilation



Professional



Modular R & P



## Decentralized ventilation



Compact T



Compact L

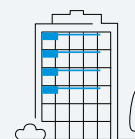

## Selection software

### ASTRA Web

- Quick AHU selection that will save you precious time, drastically reducing selection time through the new software interface.
- Very competitive solution available within the Wizard thanks to pre-uploaded parameters.
- High selection quality, thanks to the intelligence embedded within the software core.

### Quickly select your air handling unit by following the wizard:

- 1 Select the series: D-AHU Professional, D-AHU Modular R, D-AHU Modular P, Compact L and Compact T
- 2 Insert the air flow supply and return
- 3 Insert the summer/winter air supply setpoint
- 4 Insert the summer/winter outdoor and extract temperature

You will get immediately your 3D result and it's ready to customize!

Now, you will be able to modify your unit (adding or changing components) in order to have a product that meets all your needs.

When finished a technical report, price list, fan curve chart can be generated. These final reports can be downloaded in different formats.



# The working principle at a glance

Typical configurations for Daikin air handling units provide a versatile range of functions. Our system offers numerous options for customisation through an extensive range of variations and added functionality.

## Supply side

- Damper section including ventilation grilles, factory-mounted actuators
- Premium efficiency filters with factory-mounted differential pressure manometer
- Heat recovery system (cross flow and counter flow plate heat exchanger or rotary heat exchanger)
- Mixing box with damper and factory-mounted actuators
- Heating/cooling coil section with stainless steel condensate tray and drip protection
- Supply air fan, EC technology (with hinged door, opening drive monitoring, mounted and cabled lighting and ON/OFF switch)

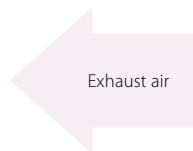

## Fans

- EC plug fan
- Forward curved fan
- Backward curved fan
- Backward airfoil blades fan
- Plug fan

## Exchangers

- Water coils
- Steam coils
- Direct expansion coil
- Superheated water coils
- Electric coils

## Humidifiers

- Evaporative humidifier without pump (loss water)
- Evaporative humidifier with re-circulating pump
- Steam humidifier with direct steam production
- Steam humidifier with local distributor
- Atomized water spray humidifier



## Plug and Play control solution

- Air flow control
- Air temperature control
- Chilled water and DX cooling system control
- Free cooling
- CO<sub>2</sub> automatic control
- Air temperature control (supply, return, ambient)
- Variable Air Volume (VAV) and Constant Air Volume (CAV) systems

## Unique section to section thermal break profile

- Thermal bridge free for the entire AHU
- Smooth interior surface with improved IAQ (Indoor Air Quality)

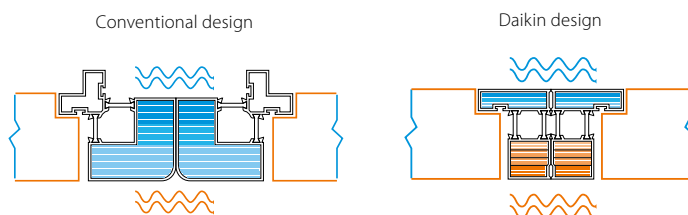

## Return side

- Premium efficiency filters with factory-mounted differential pressure manometer
- Exhaust air fan, EC technology (with hinged door, opening drive monitoring, mounted and cabled lighting and ON/OFF switch)
- Mixing box with damper and factory-mounted actuators
- Heat recovery system (cross flow and counter flow plate heat exchanger or rotary heat exchanger)
- Damper section including ventilation grilles, factory-mounted actuators



### Heat recovery systems

- Heat wheel, sensible or sorption
- Cross flow and Counter flow plate heat exchangers
- Run-around coils

### Other section

- Attenuator section
- Mixing box section with actuators or manual controlled dampers
- Empty section

### Filters

- Synthetic pleated filter
- Flat filter aluminium mesh
- Rigid bag filter
- Soft bag filter
- High efficiency filter
- Carbon absorption filter
- Carbon deodorizing filter

### Accessories

- Control features
- Frost protection
- Manometers
- Drive guard
- Roof
- ...

# Flexible solution for custom applications

## Highlights

- Air flow from 750 m<sup>3</sup>/h to 144,000 m<sup>3</sup>/h, for all customer needs
- Indoor and outdoor versions
- Custom designed to facilitate the transport and the assembly on site
- Smooth interior surface with improved IAQ (Indoor Air Quality)
- DX cooling system integration (VRV IV and ERQ coupling capability)
- Daikin Digital Control compatible
- Different heat recovery systems: heat wheel (sensible, enthalpy or sorption), cross flow and counter flow plate heat exchangers, run-around coils
- Wide range of fans selectable: EC, AC plug, belt driven (forward curved, backward curved and backward airfoil blades)
- Heating/cooling coil section with stainless steel condensate tray and drip protection
- Different humidifiers available depending on customer needs
- Premium efficiency filters with factory mounted differential pressure manometer
- Profile in anodized aluminum with or without thermal break
- Base frame in Galvanized steel, Aluminium, Stainless Steel 430 or 316
- Panel insulation in polyurethane foam or mineral wool
- Different material options selectable for internal, external panel skin: Pre-coated, Aluzinc, Aluminum, Stainless Steel 304 or 316
- Wide range of accessories
- Possibility to import BIM objects in Autodesk® Revit, thanks to a dedicated free plug-in available for **download**



# Configurations

Beside dimensioning the cross section by 1 cm, Professional AHUs can be designed for any configuration to comply with any space limitation and project specification. All configurations allow to fit any HRS, fan technology or component.

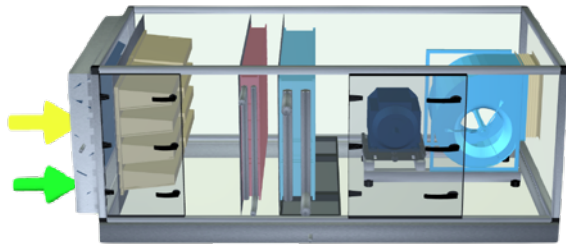

Single Deck

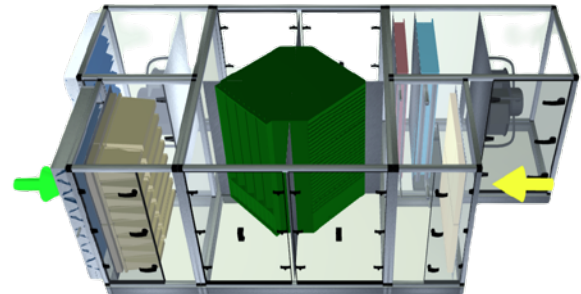

Side by Side

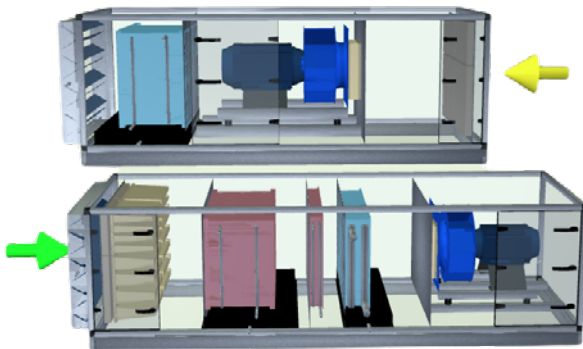

2x Horizontal

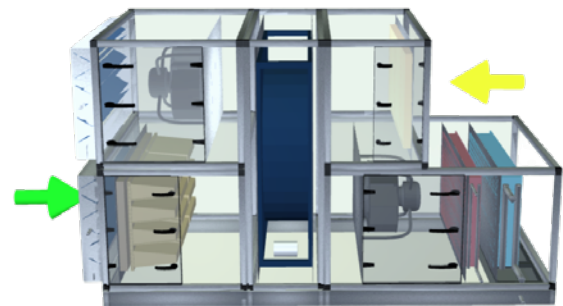

Double Deck

# Hygienic Standards

Professional air handling units are engineered to meet the highest standards of indoor air quality and hygiene, ensuring a clean and safe environment for the most demanding applications.

Daikin factories are tested and certified as manufacturer by TÜV NORD Systems GmbH & Co. KG according to German standards VDI 6022-Part 1 and DIN 1946-4, which are essential for facilities such as hospitals, laboratories, and food processing plants. By strictly adhering to these rigorous certifications, Professional AHUs ensure exceptional performance, durability, and quality. They are the optimal choice for environments where maintaining high standards of hygiene and air quality are crucial.



# BREAM & LEED certification

Daikin Professional AHU contributes in scoring points in several categories for the LEED, WELL and Bream certification programmes.





# Daikin Digital Control

Designed to offer maximum flexibility and scalability, the Daikin Digital control system is the ideal solution for advanced management of air handling units. Digital control can monitor and control every aspect of an AHU operation, optimizing energy consumption and ensuring reliable performance.



Microtech 4



NTC



CO<sub>2</sub> Probe



Humidity Probe

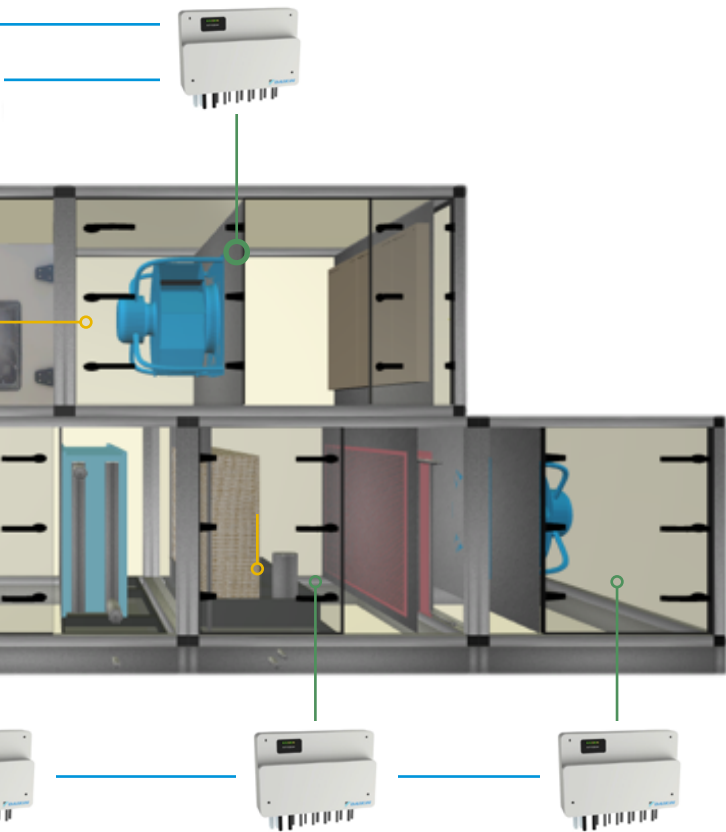

This innovative control design relies on sectional Daikin patented I/O modules: each AHU section is equipped with one or more dedicated module that collect analog or digital signals. The modules are interconnected in a continuous loop up to the central controller (Microtech 4), ensuring smooth and reliable communication among all system components by means of only one cable running through the unit, allowing for the easiest on-site setup and reducing downtime and management costs.

#### Technical Specifications:

- Number of I/O: Supports over 300 inputs and outputs, both analog or digital.
- Communication Protocols: Compatible with Building Management Systems (BMS) via Modbus or BACnet, ensuring seamless integration with existing infrastructures.
- Advanced Setpoint Control: The Digital® controller precisely ensure setpoints. Setpoints are pre-configured during factory testing based on the selections made.
- Monitoring and Alarms: Constantly monitors AHU operation, identifying malfunctions and activating alarms for prompt intervention.
- Energy Consumption Optimization: With its monitoring and control capabilities, Digital® controls helps to reduce energy consumption, improving overall system efficiency.
- Installation and Commissioning: The pre-configuration of setpoints during factory testing streamlines installation and commissioning processes. Only one cable runs through the air handling unit, simplifying on-site setup. Male-female connectors are the only plugs required for joining on-site, further enhancing ease of installation.
- Flexibility and Scalability: The sectional design and the large number of I/O allow the system to be adapted to any configurations, providing a tailored space-saving solution for every need.



Daikin I/O module



HMI



VFD



Damper Actuator



Water Coil Valve



Smoke Detector

# Side connected rotary heat recovery air handling unit

## Highlights

- 10 predefined sizes
- Airflow from 700 m<sup>3</sup>/h to 18,000 m<sup>3</sup>/h (ErP 2018)
- Rotary heat recovery (Sensible or Sorption)
- Compact design (only 720 mm depth)
- Indoor and outdoor versions
- Thermal bridge free for the entire AHU
- Smooth interior surface with improved IAQ (Indoor Air Quality)
- Indoor air quality compliant with VDI 6022 hygiene guideline
- Chilled water system control
- DX cooling system integration (VRV IV and ERQ coupling capability)
- Advanced control features
- Air flow or pressure control (Variable Air Volume - Constant Air Volume)
- Possibility to import BIM objects in Autodesk® Revit



Modular R



Modular R

## Air flow range

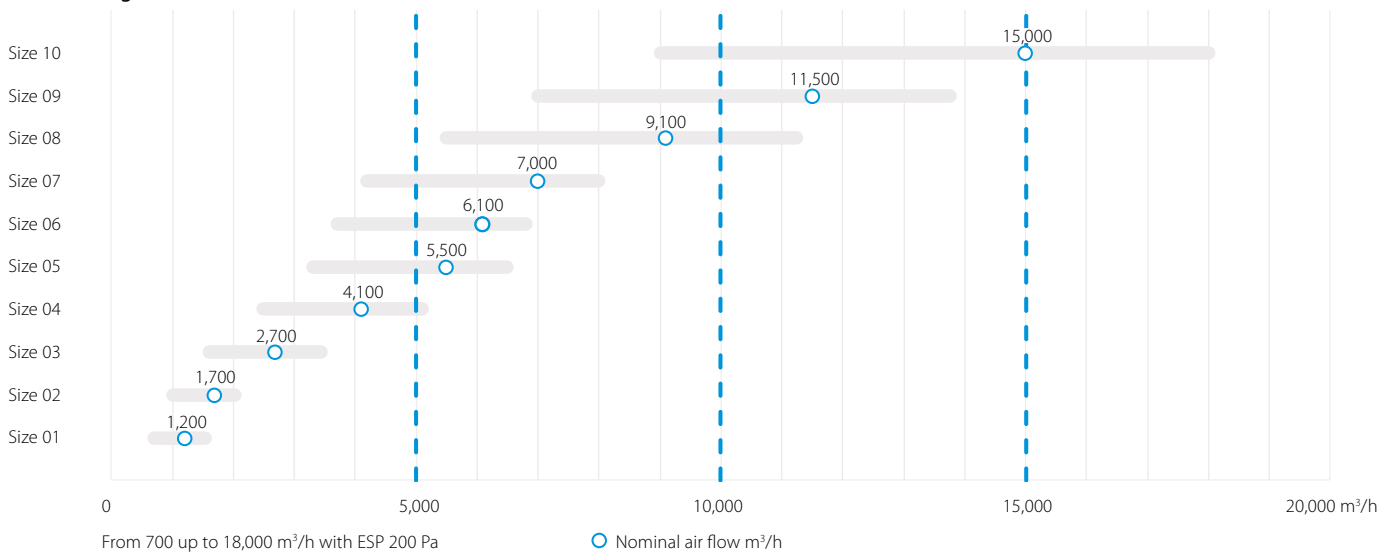

## Additional module for Modular R&P

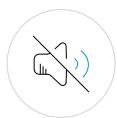

Sound attenuator on outdoor and/or indoor connections

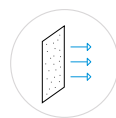

Additional filtration stage to achieve high IAQ level

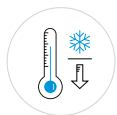

Pre heating electric coil for extremely cold climate region



Electric heater for post heating treatment



# Side connected plate heat recovery air handling unit

## Highlights

- 10 predefined sizes
- Airflow from 700 m<sup>3</sup>/h to 21,000 m<sup>3</sup>/h (ErP 2018)
- Counterflow plate heat recovery
- Compact design (only 720 mm depth)
- Indoor and outdoor versions
- Thermal bridge free for the entire AHU
- Smooth interior surface with improved IAQ (Indoor Air Quality)
- Indoor air quality compliant with VDI 6022 hygiene guideline
- Chilled water system control
- DX cooling system integration (VRV IV and ERQ coupling capability)
- Advanced control features
- Air flow or pressure control (Variable Air Volume - Constant Air Volume)
- Possibility to import BIM objects in Autodesk® Revit



Modular P



Modular P

## Air flow range

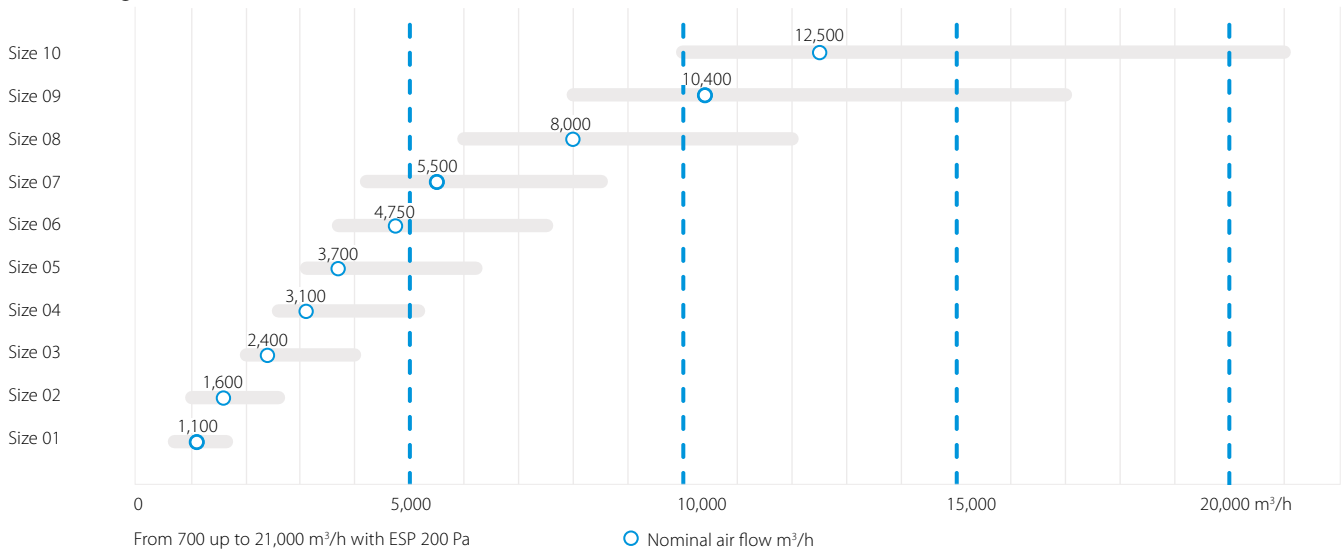

## Additional module for Modular R&P



Humidifier for humidity level control



Mixing box to allow recirculation mode



Water or DX coil for air a fully treatment

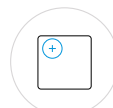

Water heating coil for post heating or heating mode only

# False ceiling heat recovery unit

## Highlights

- 6 Predefined sizes
- Plug & Play control solution
- Compact unit from 280 mm height (for air flow up to 550 m<sup>3</sup>/h)
- Wide air flow coverage from 150 to 4,000 m<sup>3</sup>/h
- Right and left configuration
- Pro (open control platform) and Smart (Daikin control platform) version
- Excellent indoor air quality (IAQ). Double filtration stage on supply and return side
- DX and water coil available as option
- BIM file available at [www.daikin.eu/BIM](http://www.daikin.eu/BIM)

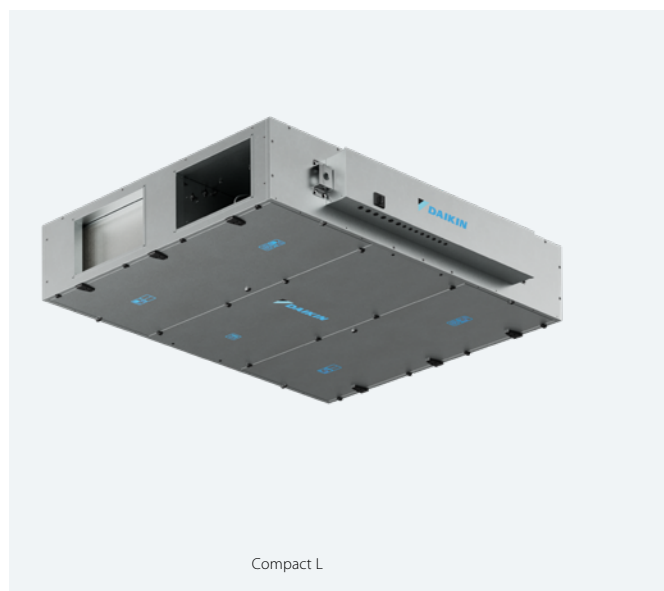

Compact L

## Air flow range

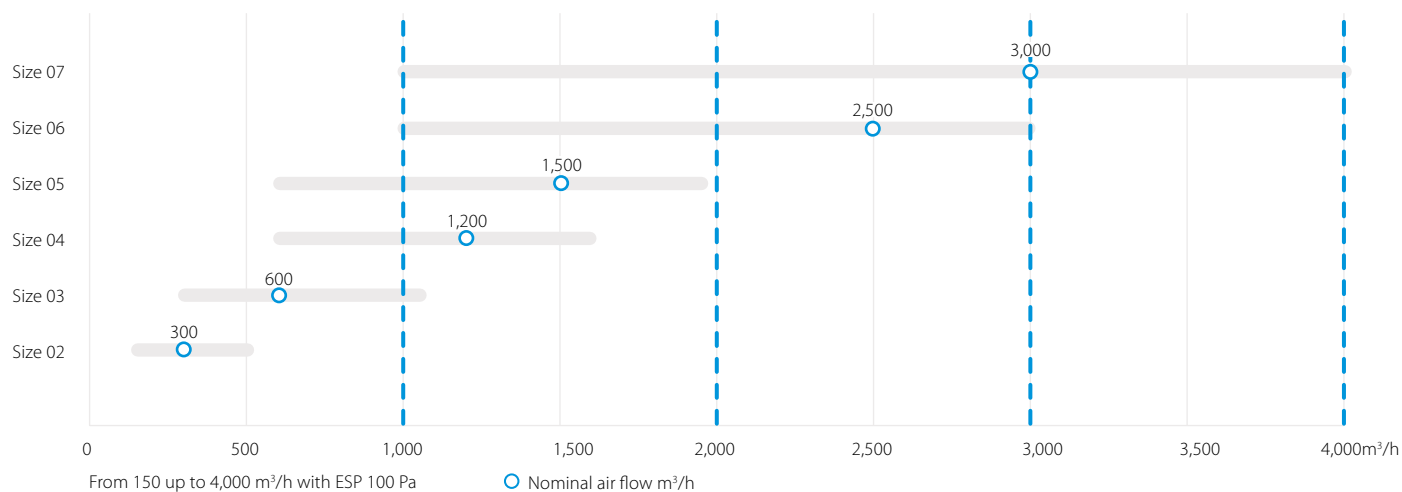

Compact L			ALB02*C* (1)	ALB03*C*	ALB04*C*	ALB05*C*	ALB06*C*	ALB07*C*
Airflow	Nominal	m³/h	300	600	1,200	1,500	2,500	3,000
Electrical supply	Phase	ph	1					
	Frequency	Hz	50/60					
	Voltage	V	220/240					
	Ampere	A	16					
Main unit dimensions	Width	mm	920	1,100	1,600		2,000	
	Height	mm	280	350	415		500	
	Length	mm	1,660	1,800	2,000			
Weight unit	Net weight	kg	115	170	255	265	310	320
	Gross weight	kg	125	180	270	280	325	335
Duct dimensions		mm	250	400	500	500	700	700
		mm	150	200	300	300	400	400

(1) ALB02\*C\* refers to all configuration available for Compact L size 02 (Smart or Pro version and right or left handing)

Please refer to Databook or Astra selection software for more details.

# Top connected heat recovery unit

## Highlights

- 5 Predefined sizes
- Plug & Play control solution
- Compact unit from 550 mm width (for unit up to 1,100 m<sup>3</sup>/h)
- Wide air flow coverage from 200 to 4,200 m<sup>3</sup>/h
- Right and left configuration
- Pro (open control platform) and Smart (Daikin control platform) version
- Excellent indoor air quality (IAQ). Up to three filtration stages: more than 90% PM1 in outdoor air are deleted achieving the best IAQ
- DX and water coil available as option
- Recirculation mixing damper (option)
- BIM file available at [www.daikin.eu/BIM](http://www.daikin.eu/BIM)



Compact T

## Air flow range

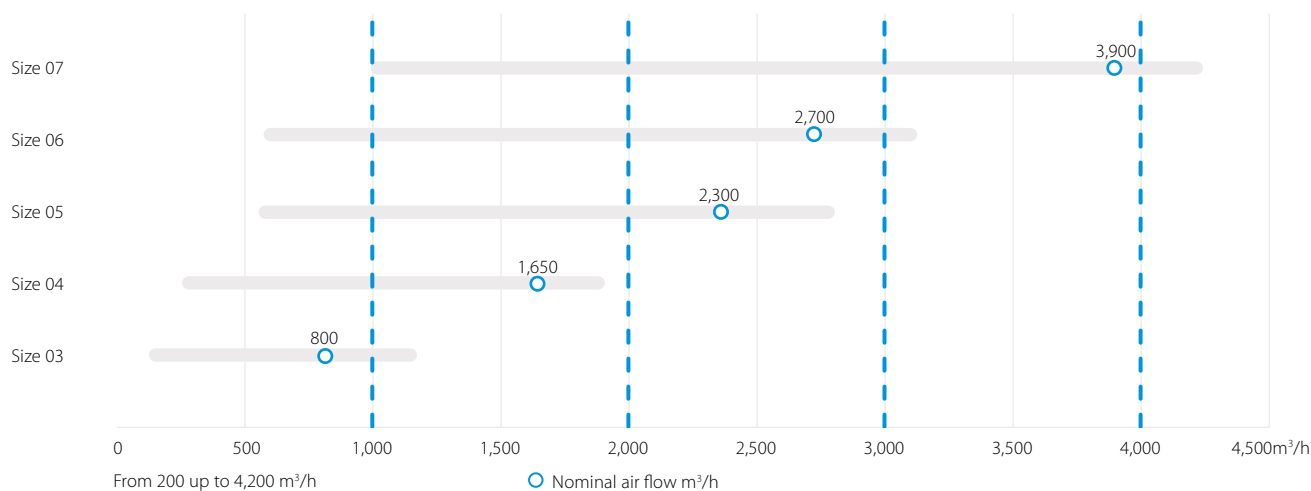

Compact T			ATB03*B* (1)	ATB04*B*	ATB05*B*	ATB06*B*	ATB07*B*
Airflow	Nominal	m <sup>3</sup> /h	800	1,650	2,300	2,700	3,900
Electrical supply	Phase	ph	1				
	Frequency	Hz	50				
	Voltage	V	230				
	Max internal fuse	A	16				
Main unit dimensions	Width	mm	550		790		890
	Height	mm	1,600		1,900	1,850	2,050
	Length (2)	mm	1,580	1,650	2,170	2,620	2,950
Duct dimensions		mm	250	315	355	400	500
Weight unit	Net weight	kg	185	230	370	475	580
	Gross weight	kg	195	240	390	505	610

(1) ATB03\*B\* refers to all configuration available for Compact T size 03 (Smart or Pro version and right or left handing)

(2) Size 05 is provided in two sections while Size 06 and 07 are provided in three sections.

Please refer to Databook or Astra selection software for more details.



## Compact L&T - Accessory list

Accessories	Compact L Pro						Compact T Pro				
	ALB02LCM ALB02RCM	ALB03LCM ALB03RCM	ALB04LCM ALB04RCM	ALB05LCM ALB05RCM	ALB06LCM ALB06RCM	ALB07LCM ALB07RCM	ATB03RBM ATB03LBM	ATB04RBM ATB04LBM	ATB05RBM ATB05LBM	ATB06RBM ATB06LBM	ATB07RBM ATB07LBM
Iso Coarse 55% (G4) Filter	ALF02G4A	ALF03G4A	ALF05G4A		ALF07G4A		ATF03G4A	ATF04G4A	ATF05G4A	ATF06G4A	ATF07G4A
ePM10 75% (M5) Filter	ALF02M5A	ALF03M5A	ALF05M5A		ALF07M5A		ATF03M5A	ATF04M5A	ATF05M5A	ATF06M5A	ATF07M5A
ePM1 50% (F7) Filter	ALF02F7A	ALF03F7A	ALF05F7A		ALF07F7A		ATF03F7A	ATF04F7A	ATF05F7A	ATF06F7A	ATF07F7A
ePM1 80% (F9) Filter	ALF02F9A	ALF03F9A	ALF05F9A		ALF07F9A		ATF03F9A	ATF04F9A	ATF05F9A	ATF06F9A	ATF07F9A
Sound attenuator	ALS0290A	ALS0390A	ALS0590A		ALS0790A		ATS0360A	ATS0460A	ATS0560A	ATS0660A	ATS0760A
Rails for door	ALA02RLA	ALA03RLA	ALA05RLA		ALA07RLA						
Duct transition	ALA02RCA	ALA03RCA	ALA05RCA		ALA07RCA						
Flexible joints	ALA02FXB	ALA03FXB	ALA05FXB		ALA07FXB						
Mixing damper									ATA05MDA	ATA06MDA	ATA07MDA
External damper	ALA02EDA	ALA03EDA	ALA05EDA		ALA07EDA		ATA03EDA	ATA04EDA	ATA05EDA	ATA06EDA	ATA07EDA
Electric pre heater <sup>1</sup>	ALD02HEFA	ALD03HEFA	ALD05HEFA		ALD07HEFA		ATD03HEFAU	ATD04HEFAU	ATD05HEFAU	ATD06HEFAU	ATD07HEFAU
Electric post heater <sup>1</sup>	ALD02HESA	ALD03HESA	ALD05HESA		ALD07HESA		ATD03HESAU	ATD04HESAU	ATD05HESAU	ATD06HESAU	ATD07HESAU
DX coil <sup>2</sup>			ALD05CDSA		ALD07CDSA		ATD03UDSAR	ATD04UDSAR	ATD05UDSAR	ATD06UDSAR	ATD07UDSAR
							ATD03UDSAL	ATD04UDSAL	ATD05UDSAL	ATD06UDSAL	ATD07UDSAL
								ATD04UDSBL	ATD05UDSBL	ATD06UDSBL	ATD07UDSBL
								ATD04UDSBR	ATD05UDSBR	ATD06UDSBR	ATD07UDSBR
WATER coil <sup>2</sup>	ALD02CWSA	ALD03CWSA	ALD05CWSA	ALD07CWSA	ATD03UWSAR	ATD04UWSAR	ATD05UWSAR	ATD06UWSAR	ATD07UWSAR		
						ATD03UWSAL	ATD04UWSAL	ATD05UWSAL	ATD06UWSAL	ATD07UWSAL	
Water pre heating coil	ALD02HWUA	ALD03HWUA	ALD05HWUA		ALD07HWUA		ATD03HWFUAU	ATD04HWFUAU	ATD05HWFUAU	ATD06HWFUAU	ATD07HWFUAU
Water post heating coil <sup>2</sup>	ALD02HWUA	ALD03HWUA	ALD05HWUA	ALD07HWUA	ATD03HWSAR	ATD04HWSAR	ATD05HWSAR	ATD06HWSAR	ATD07HWSAR		
					ATD03HWSAL	ATD04HWSAL	ATD05HWSAL	ATD06HWSAL	ATD07HWSAL		
Droplet Eliminator	ALA02DEA	ALA03DEA	ALA05DEA		ALA07DEA						
Water valve 2 way cooling/heating	ALV02CW2A	ALV03CW2A	ALV05CW2A		ALV07CW2A		ATV03CW2A	ATV04CW2A	ATV05CW2A	ATV06CW2A	ATV07CW2A
Water valve 3 way cooling/heating	ALV02CW3A	ALV03CW3A	ALV05CW3A		ALV07CW3A		ATV03CW3A	ATV04CW3A	ATV05CW3A	ATV06CW3A	ATV07CW3A
Valve modulating actuator	ATE00AMVA										
Damper modulating actuator	ATE00AMDA										
Digital PCB							ATE00DPUA				
Spring return modulating actuator	AUE00ASUA										
Frost switch	ALE00FSUA						ATE00FSUA				
CO <sub>2</sub> sensor	ALP00COA										
Humidity sensor	ALP00HUA										
Temperature probe	ALP00TEA										
Pressure transducer	AUE00PTUA										
Room Interface	ALC00822A (POL 822)										
Commissioning module	ALC00895A (POL 895)										
Modbus RTU module	ALC00902A (POL 902)										
Bacnet IP module	ALC00908A (POL 908)										
Expansion module	ALC00955A										
LonWorks Interface											
Intelligent Touch Manager											
Intelligent Tablet Controller											
Intelligent Touch Controller											
Central remote control											
Unified ON/OFF control											

### Notes

(1) For Compact T pro only, both electric heater can be used as pre and post heater

(2) For Compact T pro only, sixth digit on main unit material name has to be aligned with last digit of the coil material name (with the exception of the electric heater and water pre heating coil)

ATB0\*RBM --> ATB0\*UDSAR  
 ATB0\*RBM --> ATB0\*UDSBR  
 ATB0\*RBM --> ATB0\*UWSAR  
 ATB0\*RBM --> ATB0\*HWSAR  
 ATB0\*LBM --> ATB0\*UDSAL  
 ATB0\*LBM --> ATB0\*UDSBL  
 ATB0\*LBM --> ATB0\*UWSAL  
 ATB0\*LBM --> ATB0\*HWSAL

(3) Please refer to the selection software for more details on accessories and their incompatibilities.



# Daikin fresh air package



## Plug and play connection of AHU to Daikin VRV and ERA

The Daikin fresh air package provides a complete solution, including all unit controls (expansion valve, control box and AHU controller) and sensors factory mounted and configured.

### What is included?

- A **plug & play package** with a Daikin DX outdoor unit and Daikin Air Handling Unit
- Factory fitted and welded **DX coil, expansion valve kit and control box**
- **One point of contact**



VRV or ERA outdoor condensing unit



Daikin Air Handling Unit Professional Modular R&P Compact L&T



Factory fitted and welded DX coil, expansion valve kit and control box

Fully compatible with R-410A and R32 systems



Expansion valve (EKEXVA)



Electronic interface (EKEACB)



### Simplified business

- Unique **total solution approach** of heating, cooling and ventilation
- Off-the-shelf **compatibility** between Daikin outdoor unit and Daikin AHU
- Plug&play control for **outstanding reliability**
- **Peace-of-mind** thanks to a single point of contact

### Simple selection in 2 steps

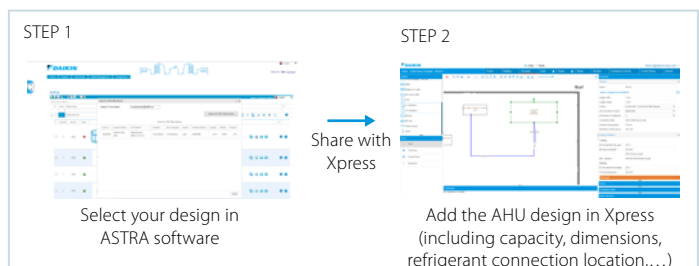



## Notes



**Daikin Europe N.V.** Naamloze Vennootschap Zandvoordestraat 300 · 8400 Oostende · Belgium · [www.daikin.eu](http://www.daikin.eu) · BE 0412 120 336 · RPR Oostende (Publisher)

01/2025 ECPEN25-401



Daikin Europe N.V. participates in the Eurovent Certified Performance programme for Fan Coil Units and Variable Refrigerant Flow systems.

Daikin Applied Europe S.p.A. participates in the Eurovent Certified Performance programme for Liquid Chilling Packages, Hydronic Heat Pumps and Air Handling Units.

Check ongoing validity of certificate: [www.eurovent-certification.com](http://www.eurovent-certification.com)



The present publication is drawn up by way of information only and does not constitute an offer binding upon Daikin Europe N.V. Daikin Europe N.V. has compiled the content of this publication to the best of its knowledge. No express or implied warranty is given for the completeness, accuracy, reliability or fitness for particular purpose of its content and the products and services presented therein. Specifications are subject to change without prior notice. Daikin Europe N.V. explicitly rejects any liability for any direct or indirect damage, in the broadest sense, arising from or related to the use and/or interpretation of this publication. All content is copyrighted by Daikin Europe N.V.